

# About CEI



## Services

CEI is an award-winning civil engineering and environmental services firm with offices in Bolton, MA, Merrimack, NH, and New Britain, CT. Founded in 1987, CEI provides premier engineering and environmental services to municipal and private clients throughout the Northeast. CEI is employee-owned with a technical staff of approximately 30, including professional engineers (civil, environmental, geotechnical, and chemical), environmental scientists, Certified Floodplain Managers (CFM), Professional Geologists (PGs), Certified Lake Managers (CLM), wetland scientists, drinking water facility operators, hydrologists and other technical staff including those expert in CADD, MicroStation, GIS, and SPECSINTACT.

Our engineering and environmental services include:

- Wetland Restoration and Regulatory Services
- Watershed Planning
- Water Supply Areas
- Wastewater
- CEI Aerobotics™ (drone services)
- Stormwater Engineering
- Water and Natural Resources
- Hazardous Waste Assessment and Remediation
- Geotechnical Engineering
- Lake and Pond Management
- Transportation and Utilities
- Flood and Drainage Management
- NPDES MS4 Services
- Facilities and Environmental Compliance
- Plan and Peer Review

*Having worked with CEI for nearly 15 years on everything from stormwater engineering, to NPDES compliance and hazardous/solid waste projects, we have come to rely on their staff to provide comprehensive, reliable and cost-effective support to our department. We highly recommend them.*

Municipal DPW Director

## Awards

- ✓ Named one of the **Best Environmental Services and Civil Engineering Firm to Work for Nationwide** annually since 2010. This award recognizes outstanding professional support, benefits and workplace environment for staff.
- ✓ Recognized as **Top Woman Led Company in NH** by Business NH Magazine.
- ✓ **Engineering Excellence Award** Finalist by the American Council of Engineering Companies (ACEC) for multiple projects.
- ✓ **Construction Management Association of America Public Project of the Year Award** (2006 \$50M-\$100M) for CEI's role as Owner's Representative (environmental services) for the design-build of the Norumbega Covered Storage Project in Weston, MA.
- ✓ U.S. EPA New England Design Professional Winner of the **Stormwater Design Competition**.





## SUMMARY OF QUALIFICATIONS

### CEI Peer and Plan Review Services

Peer reviews by professionals can help prevent problem developments, such as those with drainage problems or roadway issues that could have been prevented. For over 25 years, CEI has recognized communities' needs to have expert assistance in evaluating new projects. We have earned the respect of our client municipalities and project applicants for our technical thoroughness, objectivity, and ability to work with community representatives and proposal applicants. CEI's experienced staff of civil engineers and environmental scientists allows the firm to provide expert professional services in all areas relevant to a timely and objective peer/plan review.

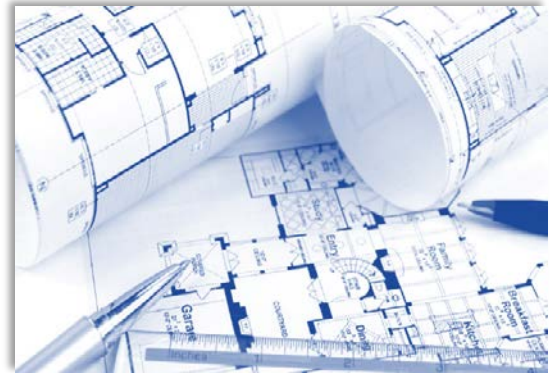

### Types of projects include:

- Commercial/Industrial
- Residential/Subdivision
- Mixed Use/Transit Oriented Redevelopment
- Municipal Capital Improvements
- ENF/EIR Review

### Review areas include:

- Engineering
- Stormwater/LID
- Wastewater/Water Supply
- Roadway/Transportation
- Hazardous Waste Remediation
- Wetlands/Watershed Protection
- Geotechnical

*"I have never received so many positive comments from our community and staff about a consultant review as I have for CEI. CEI provided review services for the largest redevelopment project our Town has ever seen. I couldn't have been more pleased with how CEI worked with the applicant and addressed the Town's concerns. We will definitely call on them again."*

Municipal Peer Review Client

### CEI peer review communities have included:

Hanover, MA	Hull, MA	Milford, MA	Ware, MA
Swansea, MA	Canton, MA	Groton, MA	Haverhill, MA
Seekonk, MA	Medfield, MA	Cheshire, MA	Westford, MA
Plymouth, MA	Westwood, MA	Pittsfield, MA	Lunenburg, MA
Falmouth, MA	Bedford, MA	Williamstown, MA	Lynnfield, MA
Scituate, MA	Lexington, MA	Montague, MA	Merrimac, MA
Randolph, MA	Andover, MA	Lancaster, MA	Rye, NH
Milton, MA	Lincoln, MA	Ludlow, MA	Peterborough, NH

**Partial List of CEI Municipal Peer/Plan Review Projects** *(We will gladly provide examples of municipal peer review deliverables upon request)*

<b>Review Project</b>	<b>Location</b>	<b>Client</b>
778 Washington Street, commercial site redevelopment	Hanover, MA	Hanover Planning Board
579 Washington Street, commercial site redevelopment	Hanover, MA	Hanover Planning Board
H & W Apartments, 40b development	Milton, MA	Milton Conservation Commission
The Residences at Great Pond NOI Review	Randolph, MA	Randolph Conservation Commission
Goodridge Estates, 40b development ( <i>vernal pool investigation</i> )	Lancaster, MA	Lancaster Dept. of Community Development & Planning
Boynton Hill Estates Peer Review – 54 Lot Subdivision	Milford, NH	Town of Milford, NH
Prime Motors Peer Review	Westwood, MA	Town of Westwood Conservation Commission
Columbia Road Site Plan Review	Hanover, MA	Hanover Planning Board
342 Circuit Street (Winslow Crossing)	Hanover, MA	Town of Hanover: Department of Municipal Inspections
Woodland Village 40(b) Plan Review, ENF review	Hanover, MA	Town of Hanover (Zoning Board of Appeals)
Residences at Stone Ridge (Phases 1 and 2), 40b development	Milford, MA	Milford Zoning Board of Appeals
Robsham Village 40b development	Milford, MA	Milford Zoning Board of Appeals
Birch Street Place 40b development	Milford, MA	Milford Zoning Board of Appeals
5A Homestead Circle, NOI Review	Bedford, MA	Bedford Conservation Commission
FEMA Floodplain Review – Residential	Bedford, MA	Bedford Conservation Commission
Medfield State Hospital Environmental Monitoring	Medfield, MA	Town of Medfield
476 Webster Street - South Shore Regional Vocational Tech	Hanover, MA	Town of Hanover: Department of Municipal Inspections
596 Washington Street - Planet Subaru Parking Expansion	Hanover, MA	Town of Hanover: Department of Municipal Inspections
1010 Turnpike Street Review	Canton, MA	Town of Canton Conservation Commission
LCB Senior Living Residence Review	Medfield, MA	Medfield Conservation Commission
Ledgemont Country Club Tennis and Pool	Seekonk, MA	Seekonk, MA
Stable Ridge Estates	Hanover, MA	Hanover Planning Board
The Parc at Medfield 40B Project Review	Medfield MA	Medfield Conservation Commission
405 Nahatan Street RDA	Westwood, MA	Town of Westwood Conservation Commission
215 High Street NOI	Westwood, MA	Town of Westwood Conservation Commission



Andover Y Peer Review	Andover, MA	Town of Andover
1810 Washington Street	Hanover, MA	Town of Hanover: Department of Municipal Inspections
Village at Seven Springs Peer Review/Inspection	Hanover, MA	Town of Hanover Planning Board
Xhengo Estates	Hanover, MA	Hanover Planning Board
2053 Washington Street	Hanover, MA	Hanover Planning Board
1226 Webster Street	Hanover, MA	Hanover Planning Board
2000 Washington Street	Hanover, MA	Hanover Planning Board
Medfield State Hospital – NOI Revised Plan	Medfield, MA	Medfield Conservation Commission
48 Milk Street NOI Review	Westwood, MA	Westwood Conservation Commission
Clapboardtree Road Residential Development NOI	Westwood, MA	Westwood Conservation Commission
Academy Hill Development	Groton, MA	Groton Conservation Commission
Medfield Hospital Redevelopment & Remediation NOI	Medfield, MA	Medfield Conservation Commission
Westwood Station Mixed-Use Transit Oriented Redevelopment	Westwood, MA	Westwood Conservation Commission
Westview Estates Development	Westwood, MA	Westwood Conservation Commission
Linwood Terrace Definitive Subdivision	Hanover, MA	Hanover Planning Board
Colburn Trust Review	Milford, NH	Milford Office of Community Development
161 Wilton Road Divine Mercy Church	Peterborough, NH	Peterborough Office of Community Development
Teixeira Park Review	Peterborough, NH	Peterborough Office of Community Development
Monadnock Community Hospital Drainage Review	Peterborough, NH	Peterborough Office of Community Development
Highland Farm Stormwater Review	Peterborough, NH	Peterborough Office of Community Development
Osgood Estates	Milford, NH	Milford Office of Community Development
The Meadows of Milford	Milford, NH	Milford Office of Community Development
Ciardelli Drainage Review	Milford, NH	Milford Office of Community Development
Wilson Farms Condos Drainage Review	Peterborough, NH	Peterborough Office of Community Development
Village Park Review	Hanover, MA	Hanover Planning Board
Tolman Road Definitive Subdivision Plan Review	Hanover, MA	Hanover Planning Board
Morse Farm Estates Definitive Subdivision Plan	Hanover, MA	Hanover Planning Board
369 Winter Street Stormwater Management Design	Hanover, MA	Hanover Planning Board



Prime Infiniti Site Plan	Hanover, MA	Hanover Planning Board
Hanover High School Site Plan	Hanover, MA	Hanover Planning Board
Hanover YMCA Arts Center	Hanover, MA	Hanover Planning Board
Hanover Senior Center	Hanover, MA	Hanover Conservation Commission
Whiting Street Definitive Subdivision Plan	Hanover, MA	Hanover Planning Board
Dick's Sporting Goods Site Plan	Hanover, MA	Hanover Planning Board
McGee Toyota Site Plan	Hanover, MA	Hanover Planning Board
Assisted Living Center Site Plan	Hanover, MA	Hanover Planning Board
241-Unit Condominium 40(b) Development	Ludlow, MA	Ludlow Conservation Commission
250-Unit 40(b) Residential Development	Scituate, MA	Scituate Conservation Commission
33-Unit Subdivision Development	Ware, MA	Ware Public Works
Tennis Club Development & Inspection Services	Scituate, MA	Scituate Conservation Commission
Bouchard Auto Development	Lancaster, MA	Lancaster Conservation Commission
Mountain View Subdivision	Cheshire, MA	Cheshire Planning Board
Waterman Subdivision	Cheshire, MA	Cheshire Planning Board
Littlefield Estates	Swansea, MA	Swansea Conservation Commission
341 Merrett Road Definitive Subdivision Plan	Lexington, MA	Lexington Planning Board
Southview Estates	Ludlow, MA	Ludlow Conservation Commission
505 Nantasket Ave.	Hull, MA	Hull Conservation Commission
Jaeschke Fruit and Flowers- Floodplain Special Permit	Pittsfield, MA	City Planner
CVS- Floodplain Special Permit	Pittsfield, MA	City Planner
Pittsfield Plaza- Floodplain Special Permit	Pittsfield, MA	City Planner
Petricca Precast Products- Site Plan Application	Pittsfield, MA	City Planner
Dunkin Donuts- Site Plan Application	Pittsfield, MA	City Planner
BDC Car Wash- Site Plan Application	Pittsfield, MA	City Planner
United Veterans- Site Plan Application	Pittsfield, MA	City Planner
Taylor Street- Floodplain Special Permit	Pittsfield, MA	City Planner
Newell Street- Floodplain Special Permit	Pittsfield, MA	City Planner



The Clark Art Institute Plan Review	Williamstown, MA	Williamstown Conservation Commission
Fall River Ave/Warehouse Imported Auto Parts	Seekonk, MA	Seekonk Planning Board
Madison Estates Subdivision	Seekonk, MA	Seekonk Planning Board
Caleb Estates Subdivision	Seekonk, MA	Seekonk Planning Board
Autumn Woods Abbreviated NOI	Scituate, MA	Scituate Conservation Commission
Montessori Community School Septic System	Scituate, MA	Scituate Conservation Commission
Whitcomb Pines Development – Mann Lot Road	Scituate, MA	Scituate Conservation Commission
206 First Parish Road Development	Scituate, MA	Scituate Conservation Commission
192 Thomas Clapp Road	Scituate, MA	Scituate Conservation Commission
770 First Parish Road Development	Scituate, MA	Scituate Conservation Commission
97 Lawson Road	Scituate, MA	Scituate Conservation Commission
Tilden Farms Development	Scituate, MA	Scituate Conservation Commission
Stockbridge Woods 40B Development	Scituate, MA	Scituate Conservation Commission
Musquashcut Avenue Development	Scituate, MA	Scituate Conservation Commission
509 Clapboardtree Street	Westwood, MA	Town of Westwood
South Row Elementary School Playground Inspection	Chelmsford, MA	South Row Elementary School PTO
Webster Village Stormwater Management Review	Hanover, MA	Town of Hanover
University Station Redevelopment	Westwood, MA	Westwood Conservation Commission
Longmeadow Drive Restoration	Westwood, MA	Westwood Conservation Commission
Grove Street Resource Area Review	Westwood, MA	Westwood Conservation Commission
Xaverian Brothers High School NOI Review	Westwood, MA	Westwood Conservation Commission
West Mill Street Review	Medfield, MA	Medfield Conservation Commission
Montrose School Expansion Review	Medfield, MA	Medfield Conservation Commission
Cherry Tree Lane Review	Groton, MA	Groton Conservation Commission
Groton Electric Light Department	Groton, MA	Groton Planning/Conservation Joint
Groton Fire Station	Groton, MA	Groton Planning Board
River Run Development	Plymouth, MA	Plymouth Planning Board
Medfield Hospital Redevelopment & Remediation	Medfield, MA	Medfield Conservation Commission



1800 Washington St Commercial Site Plan	Hanover, MA	Hanover Planning Board
Nash Landing Definitive Subdivision Plan	Hanover, MA	Hanover Planning Board
1104-1112 Washington Street Commercial Site Plan	Hanover, MA	Hanover Planning Board
62 Industrial Way Industrial Site Plan	Hanover, MA	Hanover Planning Board
35 Industrial Way Industrial Site Plan	Hanover, MA	Hanover Planning Board
577 Circuit Street Stormwater Management Design	Hanover, MA	Hanover Planning Board
74 Industrial Way Site Plan	Hanover, MA	Hanover Planning Board
King Street Recreational Complex	Hanover, MA	Hanover Planning Board
1 Saturn Drive Site Plan	Hanover, MA	Hanover Planning Board
Mercedes Site Plan	Hanover, MA	Hanover Planning Board
Hanover Target	Hanover, MA	Hanover Planning Board
59 Old Webster St Levangie Electric Co Site Plan	Hanover, MA	Hanover Planning Board
1792 Washington St Sullivan Tire Site Plan	Hanover, MA	Hanover Planning Board
353 Circuit St Industrial Bldg. Site Plan	Hanover, MA	Hanover Planning Board
YMCA Treatment Plan Site Plan	Hanover, MA	Hanover Planning Board
Starland Recreation Center Site Plan	Hanover, MA	Hanover Planning Board
111 Mayflower Drive Site Plan Review	Hanover, MA	Hanover Planning Board
Common Drive, 662 Center Street, drainage review	Hanover, MA	Hanover Planning Board
Boston Bowl Site Plan Review	Hanover, MA	Hanover Planning Board
1877 Washington St Site Plan Review	Hanover, MA	Hanover Planning Board
2144 Washington St Site Plan Review	Hanover, MA	Hanover Planning Board
357 Columbia Road Site Plan Review	Hanover, MA	Hanover Planning Board
Wendy's Site Plan Review	Hanover, MA	Hanover Planning Board
285 Circuit Street Site Plan Review	Hanover, MA	Hanover Planning Board
Hanover Mall Wastewater Treatment Plant Site Plan Review	Hanover, MA	Hanover Planning Board
Twin Fawn Drive drainage review	Hanover, MA	Hanover Planning Board
2117 Washington St site plan review	Hanover, MA	Hanover Planning Board
Webster Village 40(b) Drainage Review	Hanover, MA	Town of Hanover (Zoning Board of Appeals)





Kennedy Building 4o(b) redevelopment site plan review	Hanover, MA	Town of Hanover (Zoning Board of Appeals)
Quarry Pond Village 40(b)	Milford, MA	Milford Zoning Board of Appeals
Beaver Pond Commons 40(b)	Milford, MA	Milford Zoning Board of Appeals
Gas Station Engineering Review	Bedford, MA	Town of Bedford
22-Unit Subdivision Downstream Impact Analysis	Cheshire, MA	Town of Bedford
150-Unit Condominium Development	Milford, MA	Milford Water Company
Natural Gas Pipeline	Swansea, MA	Swansea Conservation Commission
MBTA Greenbush Line	Scituate, MA	Town of Scituate
Lancaster Golf Center Stormwater Management Design	Lancaster, MA	Lancaster Planning Board
Fielding Estates Definitive Subdivision Plan	Westford, MA	Westford Planning Board
Lawnscapes	Swansea, MA	Swansea Conservation Commission
Swansea Commons	Swansea, MA	Swansea Conservation Commission
The Inn at Hastings Park	Lexington, MA	Lexington Conservation Commission
The Views at Pontoosuc Lake	Pittsfield, MA	Pittsfield Planning Board
Williams College Athletic Facilities Drainage Review	Williamstown, MA	Williamstown Conservation Commission
Chelsea Road/Greenwood Estates Drainage Review	Seekonk, MA	Seekonk Planning Board
Girard Estates Subdivision	Seekonk, MA	Seekonk Planning Board
Pine Hill Estates Subdivision	Seekonk, MA	Seekonk Planning Board
Jacob Hill Estates Subdivision	Seekonk, MA	Seekonk Planning Board
230 High Street	Westwood, MA	Westwood Conservation Commission
128 High Rock Street	Westwood, MA	Westwood Conservation Commission
Crystal Avenue Terrace	Westwood, MA	Westwood Conservation Commission
Morgan Farm Road Development	Westwood, MA	Westwood Conservation Commission
Sandy Valley Road Equestrian Center	Westwood, MA	Westwood Conservation Commission







## Key Peer Review Project Staff

Summaries for CEI's key peer review staff are provided below. The key staff listed below will be supported by CEI's talented staff engineers and staff scientists with experience in municipal peer review projects, and by other project technical staff on an as needed basis for related tasks (e.g., GIS mapping). CEI's staff are available to begin work immediately on behalf of the Town and we commit to maintaining a schedule to meet the Town's timeframes.



### **Bob Hartzel, CLM – Principal Scientist**

Mr. Hartzel leads CEI's Ecological Services practice and has over 25 years of experience leading wetland, water resources, watershed assessment and ecological restoration projects. He is a professional wetland scientist and Certified Lake Manager. Mr. Hartzel provides expertise in aquatic and wetland ecology as they relate to wetland delineation, wetland mitigation design, environmental permitting, limnological investigations, stream bioassessment, and wildlife habitat investigations (including vernal pool certification). Mr. Hartzel has successfully obtained numerous of wetland regulatory approvals for sites throughout the northeast United States, and has led the design of wetland mitigation for projects ranging from residential development to complex Superfund sites. He has led numerous third-party plan and permit reviews for municipal clients in Massachusetts and New Hampshire.



### **Matt Lundsted, P.E., CFM – Principal Engineer**

Mr. Lundsted leads CEI's civil engineering practice and has over 32 years of experience in civil and environmental engineering with a focus on stream and culvert restoration, small bridge design, LID/green infrastructure, stormwater assessment and BMP design, flood management, construction inspection and management, and cost estimation. Mr. Lundsted provides senior technical oversight for all engineering aspects of CEI's municipal peer review projects. He has worked extensively on stormwater structural designs, culvert and small bridge projects, and ecological restoration projects. He is a registered Professional Engineer and Certified Floodplain Manager.



### **Stephanie Hanson, Principal Scientist**

Ms. Hanson is a Principal Scientist and Certified Ecologist with extensive experience in inland, coastal and estuarine wetlands assessment/peer review, wetland delineation, watershed planning, natural resource area review and restoration. She has managed multiple wetlands, water quality, watershed protection and stormwater projects that have included resource area delineation, assessment, and water quality monitoring. She is experienced in all aspects of local, state, and federal environmental permitting. She has worked with communities on bylaw development and has provided peer review for Conservation Commissions throughout Massachusetts, including multiple 40B projects.



**Curt Busto, Project Review Engineer/ Site Inspector**

Mr. Busto is a CEI Project Review Engineer and Site Inspector with experience in stormwater BMP design, drainage system engineering, construction services, peer reviews, and regulatory inspection. He has completed watershed management plans and designed numerous stormwater BMPs for water quality improvement projects. He has worked with various municipalities to complete peer reviews and provide regulatory inspection related to stormwater management and wetlands protection.



**Elisha Musgraves, Project Review Engineer, EIT**

Ms. Musgraves is a CEI Project Engineer with a variety of experience working on civil and environmental engineering projects, as well as permitting and regulatory compliance. She has served as Project Engineer in the field and has worked on multiple projects that have included technical report writing, environmental impact analysis, wetland delineation, hydraulic structure inspection, regulatory compliance, and engineering design. She is experienced in conducting conservation and planning peer reviews, assessment of stormwater controls, and flood modeling. She has experience working on Illicit Discharge Detection and Elimination Plans (IDDE), Stormwater Management Programs (SWMP) and Stormwater Pollution Prevention Plans (SWPPP).

**PEER REVIEW REFERENCES**

Client references for municipal peer review projects are listed below.

Contact	Email / Phone Number
<b>Sandra MacFarlane</b> Town of Hanover, Conservation Agent	sandra.macfarlane@hanover-ma.gov 781-826-6505
<b>Steve Ivas</b> Town of Milton, Conservation Agent	spivas@comcast.net 781.659.1690
<b>Karon Skinner Catrone</b> Town of Westwood, Conservation Agent	781-251-2580 kcatrone@townhall.westwood.ma.us
<b>Robert E. Moore, Jr.</b> City of Haverhill Environmental Health Technician	rmoore@cityofhaverhill.com 978-374-2334
<b>Adrienne St. John</b> Town of Bedford DPW Public Works Engineer	astjohn@bedfordma.gov (781) 275-7605 x 4256
<b>Gerry Moody</b> Town of Milford, Town Counsel	gmoody@townofmilford.com (508) 797-8377
<b>Michelle Collette, AICP</b> Town of Groton, Planning Administrator	mcollette@townofgroton.org (978) 448-1105
<b>Jennifer L. Burney</b> Town of Lincoln Director of Planning and Land Use	burneyj@lincolntown.org 781-826-6505